

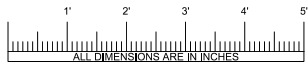

705 13TH STREET, LAKE PARK, FL
800-848-6652

Philadelphia Police Marine Unit Philadelphia, PA

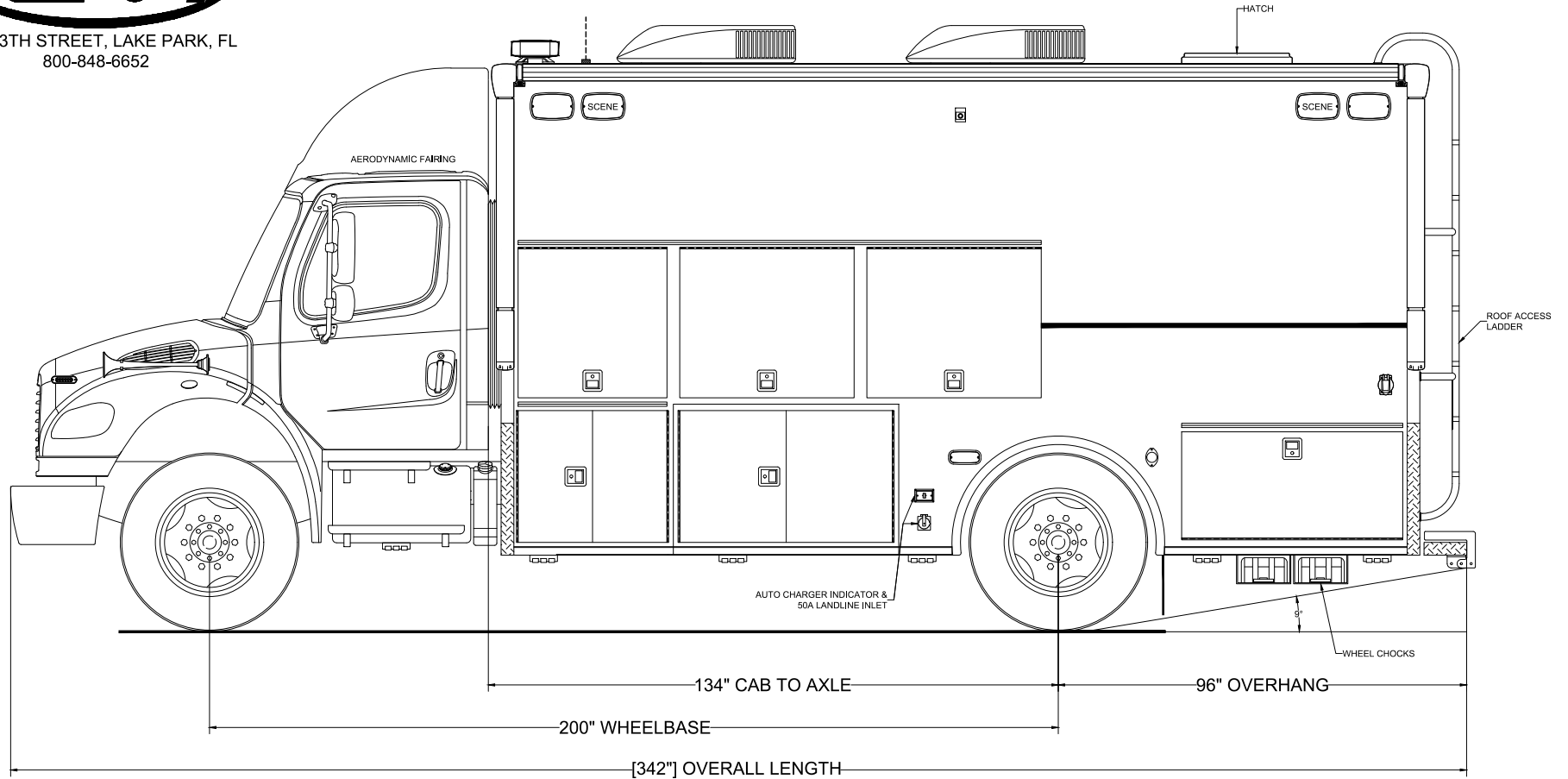

Streetside Overall

PRELIMINARY

NOTICE: THIS DRAWING IS A REPRESENTATION OF THE VEHICLE AND/OR COMPONENTS AS DESCRIBED IN THE SPECIFICATIONS PER THE DATE SHOWN. EVI RESERVES THE RIGHT TO MAKE CHANGES, AS NECESSARY, DURING THE PRODUCTION PROCESS TO ACCOMMODATE BEST MANUFACTURING PROCESSES AND TO ENSURE WE PROVIDE A CONSISTENTLY HIGH QUALITY PRODUCT.

REVISION	DATE	DESCRIPTION
REVISION 1	NP - 11/15/24	INITIAL DESIGN
REVISION 2	NP - 11/25/24	REVISED DESIGN
REVISION 3	NP - 12/11/24	REVISED DESIGN
REVISION 4	DF - 01/08/25	REVISED DESIGN
REVISION 5	-	-
REVISION 6	-	-

THESE DESIGN/ENGINEERING DRAWING(S) ARE THE PROPERTY OF EMERGENCY VEHICLES, INC. THEY ARE PROPRIETARY AND ARE FOR THE EXCLUSIVE USE OF YOUR ENTITY. ANY DIVULGING OF THIS DATA TO A THIRD PARTY IS PROHIBITED.

DATE: 09/25/24

SALES/DWG/Philadelphia/18Ft Water Rescue/NP/09252024



705 13TH STREET, LAKE PARK, FL
800-848-6652

Philadelphia Police Marine Unit Philadelphia, PA

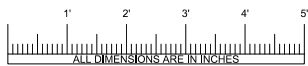
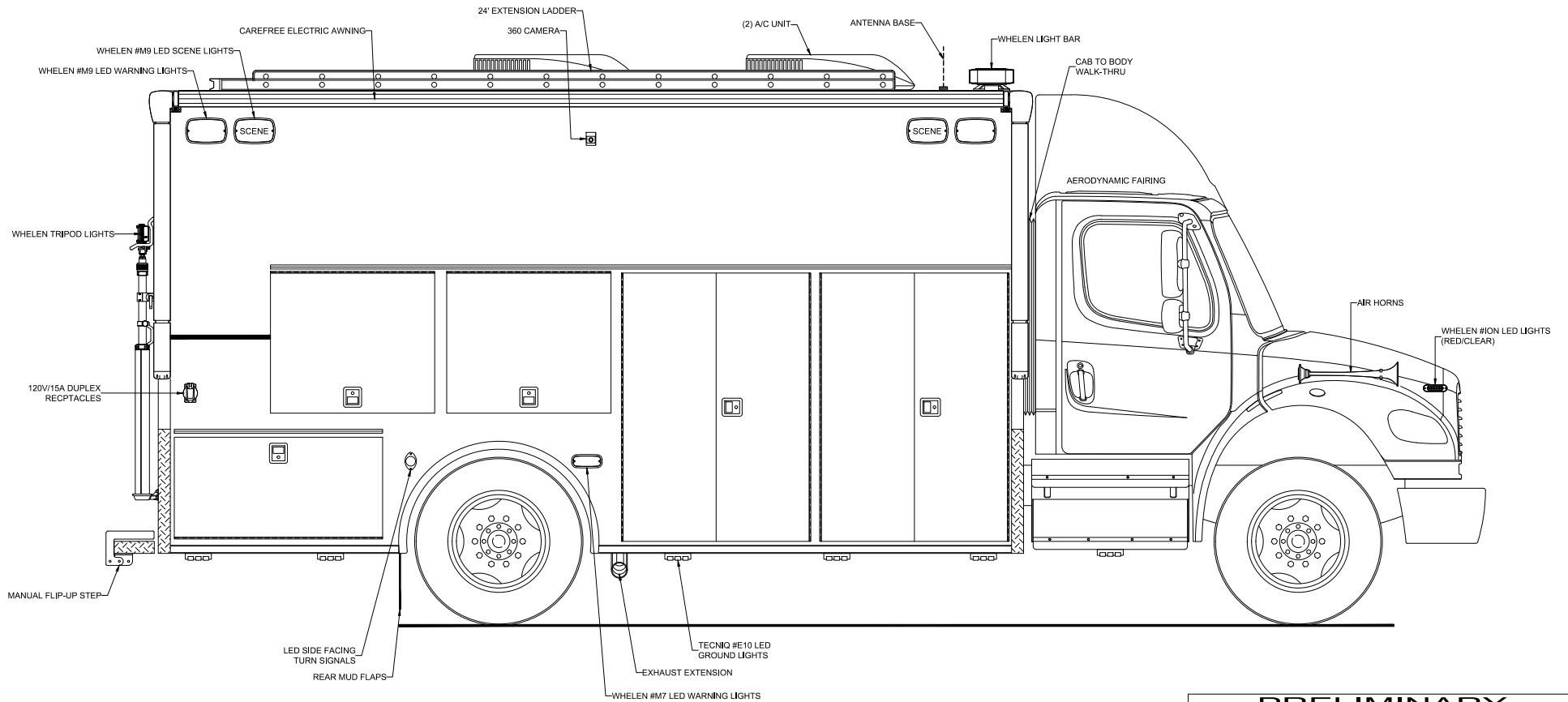

Curbside Overall

PRELIMINARY

NOTICE: THIS DRAWING IS A REPRESENTATION OF THE VEHICLE AND/OR COMPONENTS AS DESCRIBED IN THE SPECIFICATIONS PER THE DATE SHOWN. EVI RESERVES THE RIGHT TO MAKE CHANGES, AS NECESSARY, DURING THE PRODUCTION PROCESS TO ACCOMMODATE BEST MANUFACTURING PROCESSES AND TO ENSURE WE PROVIDE A CONSISTENTLY HIGH QUALITY PRODUCT.

REVISION 1	NP - 11/19/24	THESE DESIGN/ENGINEERING DRAWING(S) ARE THE PROPERTY OF EMERGENCY VEHICLES, INC. THEY ARE PROPRIETARY, AND ARE FOR THE EXCLUSIVE USE OF YOUR ENTITY. ANY DIVULGING OF THIS DATA TO A THIRD PARTY IS PROHIBITED.	DATE: 09/25/24
REVISION 2	NP - 11/25/24		
REVISION 3	NP - 12/11/24		
REVISION 4	DF - 01/08/25		
REVISION 5	-		
REVISION 6	-		

SALESDWG/Philadelphia/18Ft Water Rescue/NP/09252024



705 13TH STREET, LAKE PARK, FL
800-848-6652

Philadelphia Police Marine Unit Philadelphia, PA

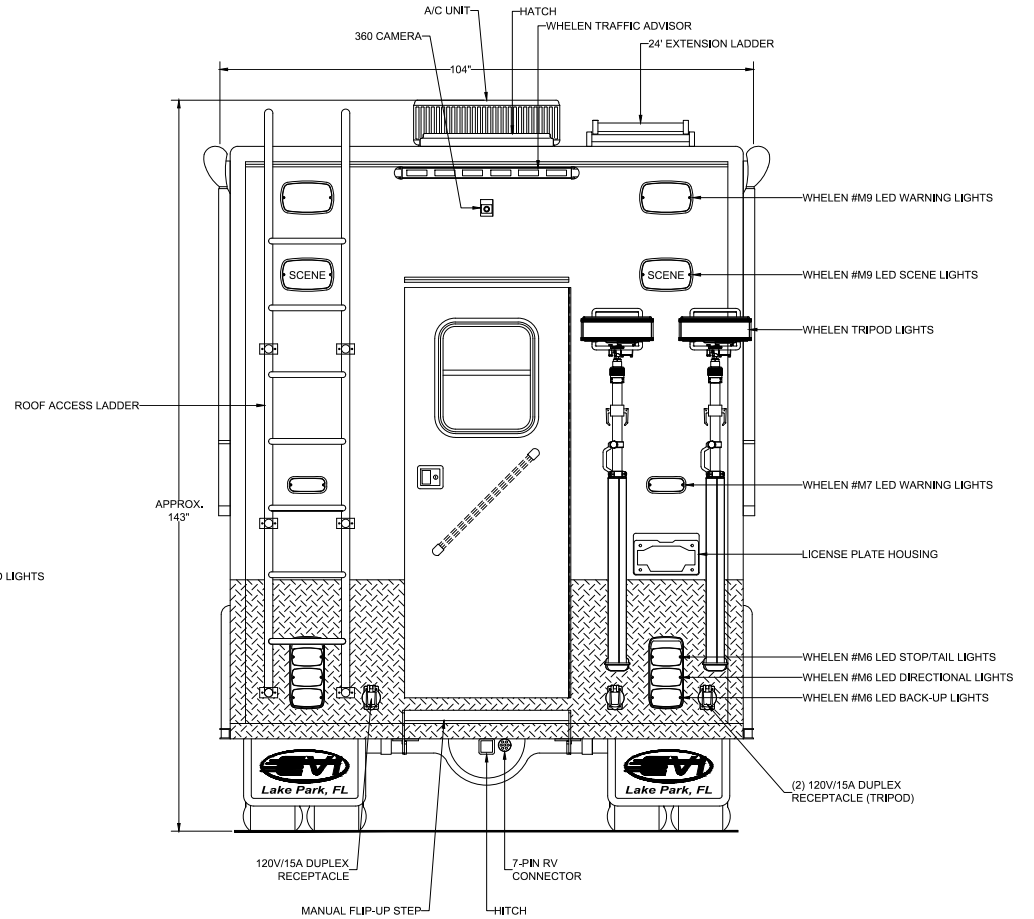
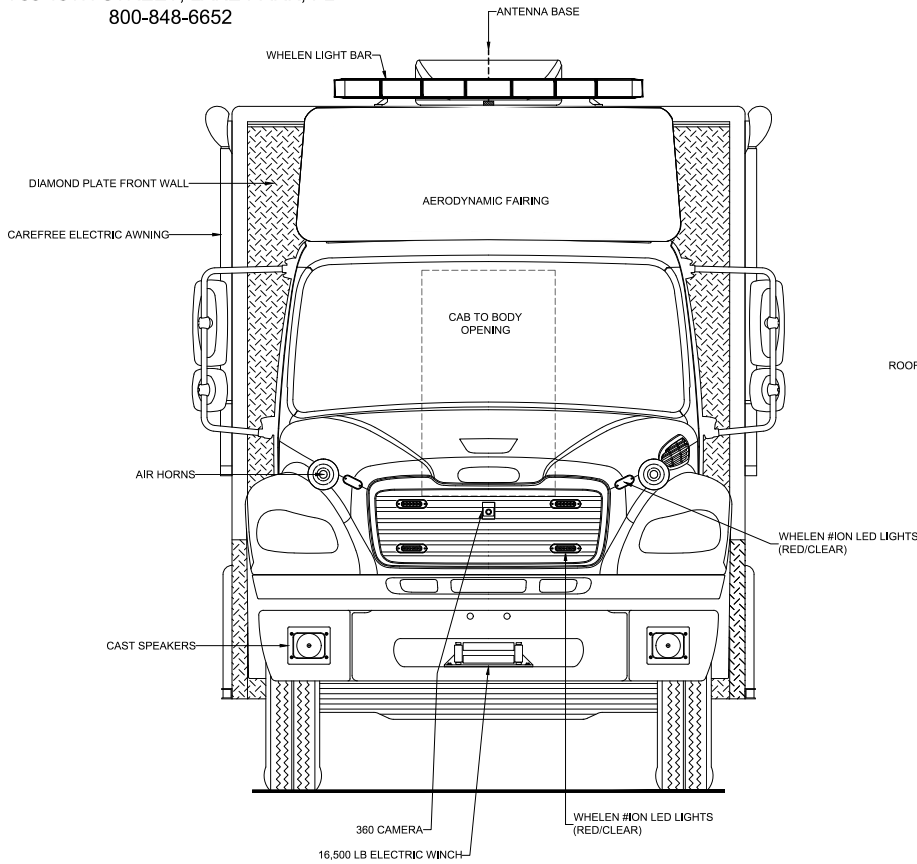

Front Rear

PRELIMINARY

NOTICE: THIS DRAWING IS A REPRESENTATION OF THE VEHICLE AND/OR COMPONENTS AS DESCRIBED IN THE SPECIFICATIONS PER THE DATE SHOWN. EVI RESERVES THE RIGHT TO MAKE CHANGES, AS NECESSARY, DURING THE PRODUCTION PROCESS TO ACCOMMODATE BEST MANUFACTURING PROCESSES AND TO ENSURE WE PROVIDE A CONSISTENTLY HIGH QUALITY PRODUCT.

REVISION 1	NP - 11/15/24	THESE DESIGN/ENGINEERING DRAWING(S) ARE THE PROPERTY OF EMERGENCY VEHICLES, INC. THEY ARE PROPRIETARY, AND ARE FOR THE EXCLUSIVE USE OF YOUR ENTITY. ANY DIVULGING OF THIS DATA TO A THIRD PARTY IS PROHIBITED	DATE09/25/24
REVISION 2	NP - 11/25/24		
REVISION 3	NP - 12/11/24		
REVISION 4	DF - 01/08/25		
REVISION 5	-		
REVISION 6	-		



705 13TH STREET, LAKE PARK, FL
800-848-6652

Philadelphia Police Marine Unit Philadelphia, PA

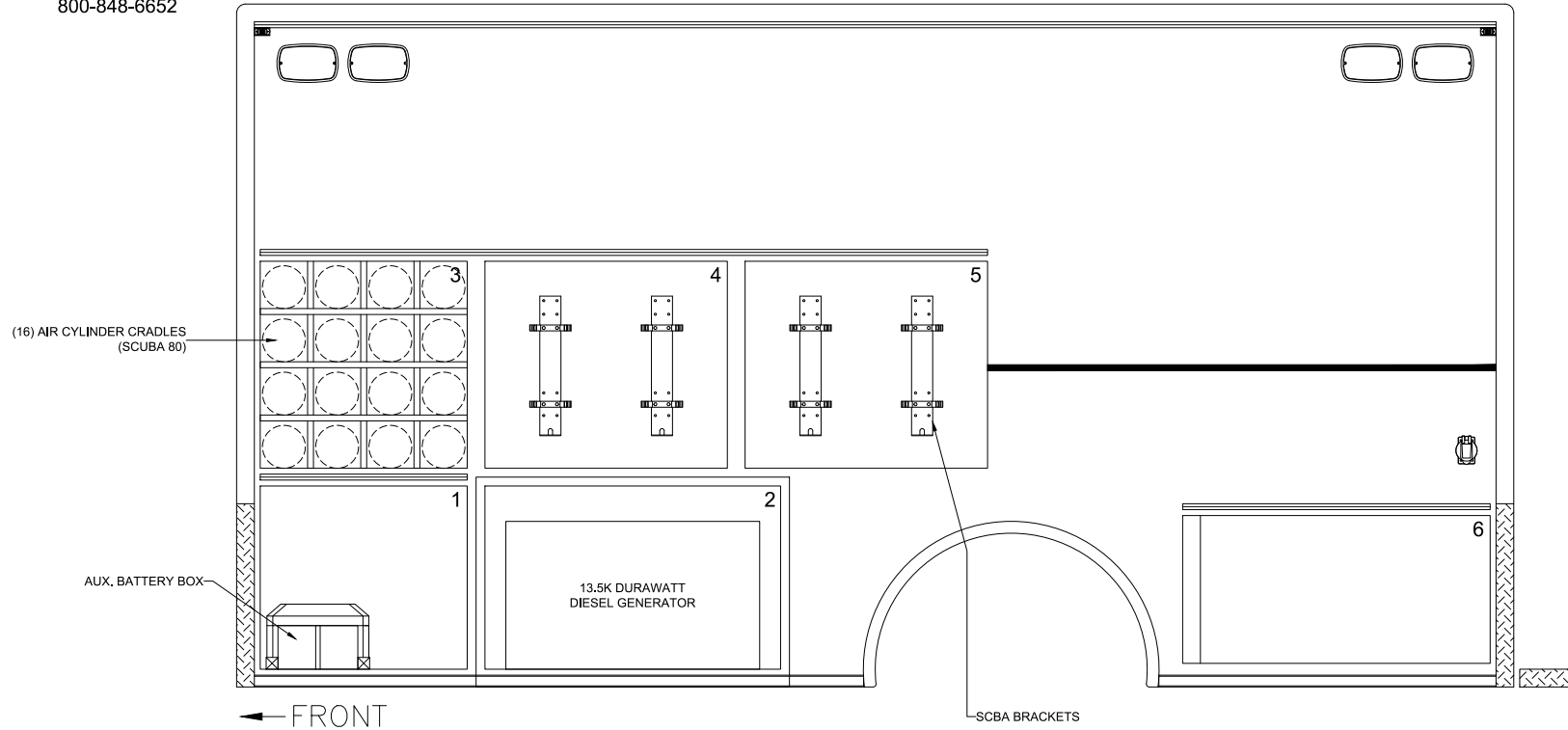

- COMPARTMENT LEGEND**
 COMPT.#1 - 35"W X 31"H X 26"D
 COMPT.#2 - 50"W X 31"H X 27"D
 COMPT.#3 - 35"W X 35"H X 30"D
 COMPT.#4 - 41"W X 35"H X 26"D
 COMPT.#5 - 41"W X 35"H X 26"D
 COMPT.#6 - 52"W X 25"H X 26"D



Streetside Body

PRELIMINARY

NOTICE: THIS DRAWING IS A REPRESENTATION OF THE VEHICLE AND/OR COMPONENTS AS DESCRIBED IN THE SPECIFICATIONS PER THE DATE SHOWN. EVI RESERVES THE RIGHT TO MAKE CHANGES, AS NECESSARY, DURING THE PRODUCTION PROCESS TO ACCOMMODATE BEST MANUFACTURING PROCESSES AND TO ENSURE WE PROVIDE A CONSISTENTLY HIGH-QUALITY PRODUCT.

REVISION 1	NP - 11/15/24	THESE DESIGN/ENGINEERING DRAWINGS ARE THE PROPERTY OF EMERGENCY VEHICLES, INC. THEY ARE PROPRIETARY, AND ARE FOR THE EXCLUSIVE USE OF YOUR ENTITY. ANY DIVULGING OF THIS DATA TO A THIRD PARTY IS PROHIBITED.	DATE:09/25/24
REVISION 2	NP - 11/25/24		
REVISION 3	NP - 12/11/24		
REVISION 4	DF - 01/08/25		
REVISION 5	-		
REVISION 6	-		



705 13TH STREET, LAKE PARK, FL
800-848-6652

Philadelphia Police Marine Unit Philadelphia, PA

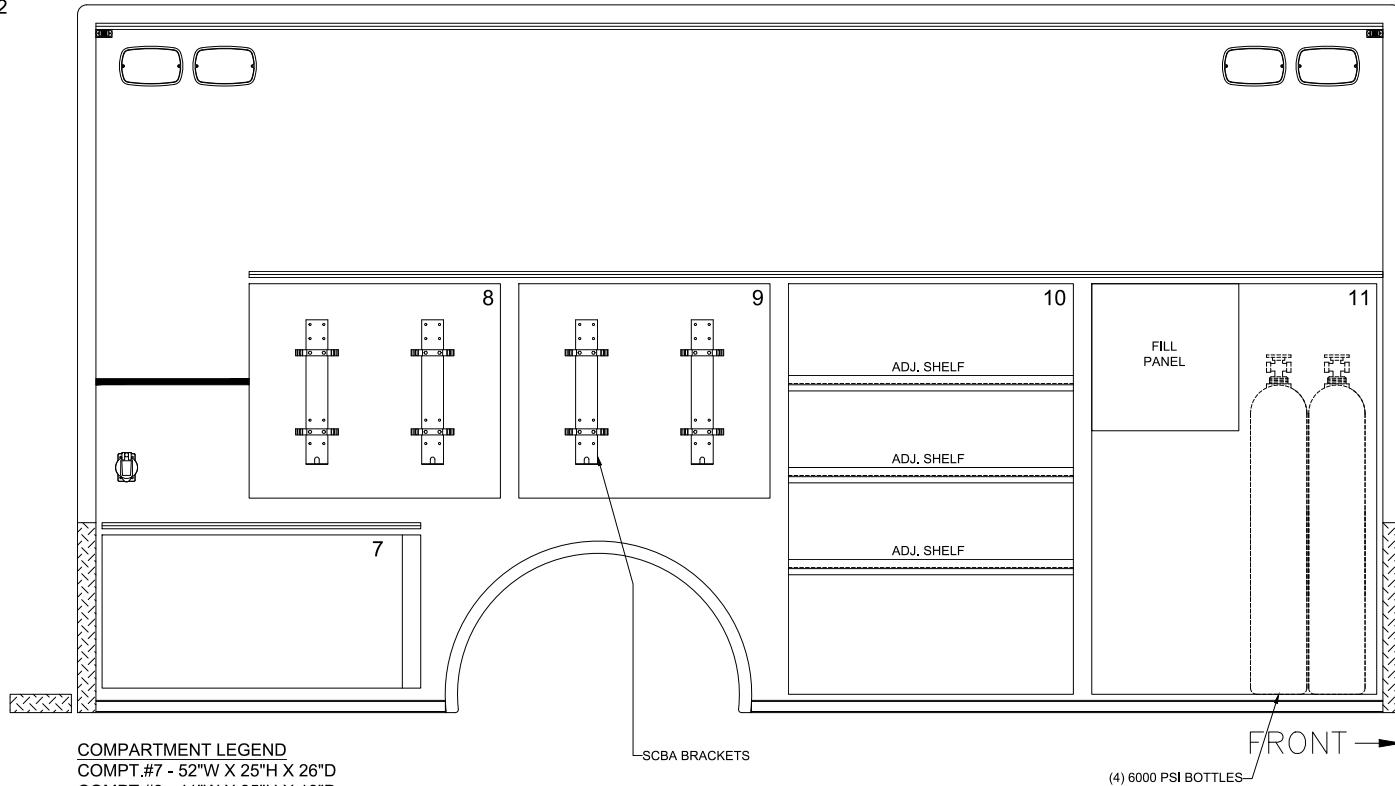

COMPARTMENT LEGEND
 COMPT.#7 - 52"W X 25"H X 26"D
 COMPT.#8 - 41"W X 35"H X 18"D
 COMPT.#9 - 41"W X 35"H X 18"D
 COMPT.#10 - 46.5"W X 67"H X 26"D
 COMPT.#11 - 46.5"W X 67"H X 26"D

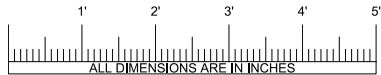

Curbside Body

PRELIMINARY

NOTICE: THIS DRAWING IS A REPRESENTATION OF THE VEHICLE AND/OR COMPONENTS AS DESCRIBED IN THE SPECIFICATIONS PER THE DATE SHOWN. EVI RESERVES THE RIGHT TO MAKE CHANGES, AS NECESSARY, DURING THE PRODUCTION PROCESS TO ACCOMMODATE BEST MANUFACTURING PROCESSES AND TO ENSURE WE PROVIDE A CONSISTENTLY HIGH QUALITY PRODUCT.

REVISION 1	NP - 11/15/24	THESE DESIGN/ENGINEERING DRAWING(S) ARE THE PROPERTY OF EMERGENCY VEHICLES, INC. THEY ARE PROPRIETARY, AND ARE FOR THE EXCLUSIVE USE OF YOUR ENTITY. ANY DIVULGING OF THIS DATA TO A THIRD PARTY IS PROHIBITED	DATE: 09/25/24
REVISION 2	NP - 11/25/24		
REVISION 3	NP - 12/11/24		
REVISION 4	DF - 01/08/25		
REVISION 5	-		
REVISION 6	-		

SALESDWG/Philadelphia18Ft Water Rescue/NP/09252024



705 13TH STREET, LAKE PARK, FL
800-848-6652

Philadelphia Police Marine Unit Philadelphia, PA

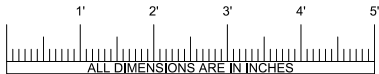
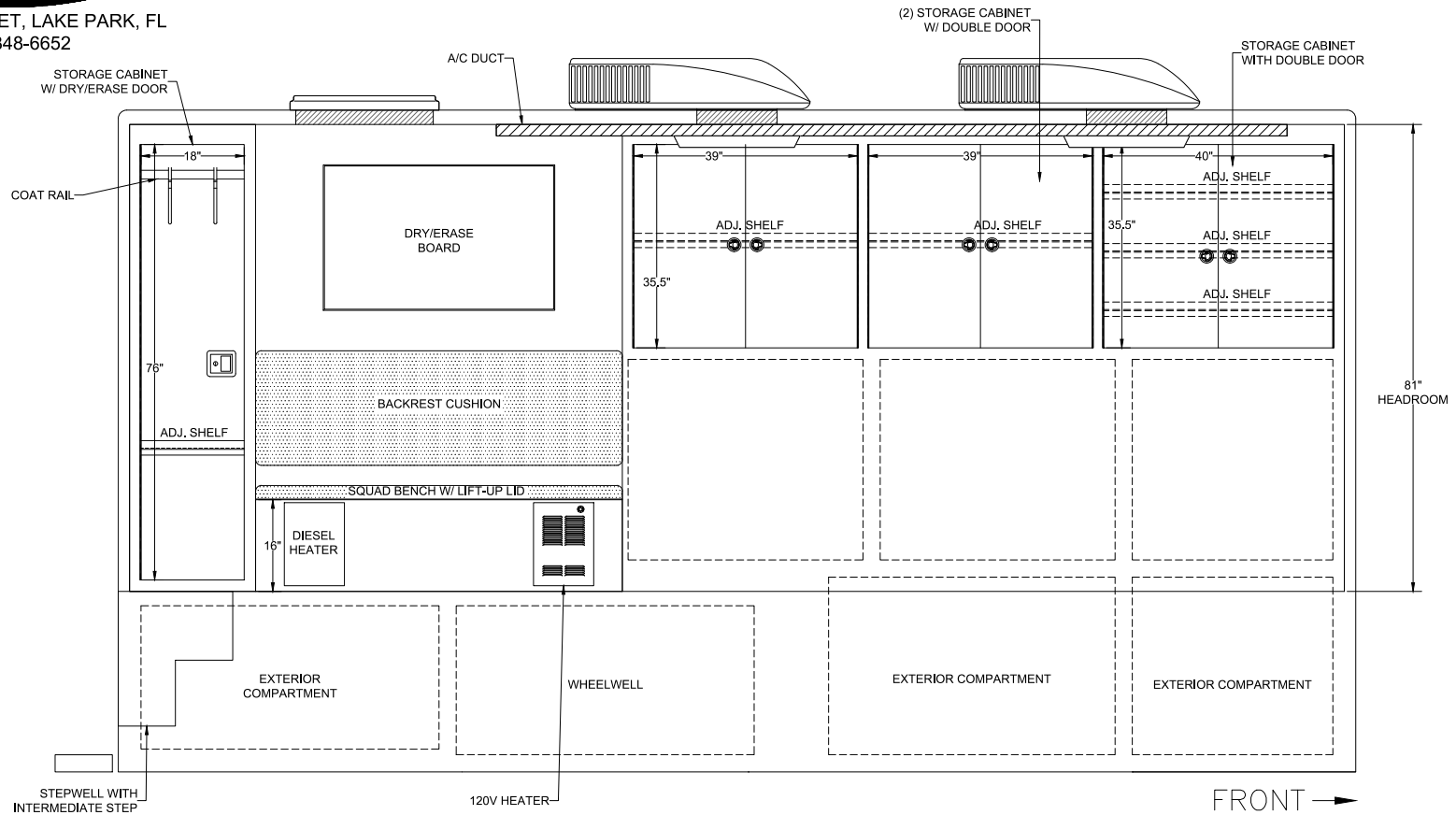

Streetside Interior

PRELIMINARY

NOTICE: THIS DRAWING IS A REPRESENTATION OF THE VEHICLE AND/OR COMPONENTS AS DESCRIBED IN THE SPECIFICATIONS PER THE DATE SHOWN. EVA RESERVES THE RIGHT TO MAKE CHANGES, AS NECESSARY, DURING THE PRODUCTION PROCESS TO ACCOMMODATE BEST MANUFACTURING PROCESSES AND TO ENSURE WE PROVIDE A CONSISTENTLY HIGH QUALITY PRODUCT.

REVISION 1	NP - 11/15/24	THESE DESIGN/ENGINEERING DRAWING(S) ARE THE PROPERTY OF EMERGENCY VEHICLES, INC. THEY ARE PROPRIETARY, AND ARE FOR THE EXCLUSIVE USE OF YOUR ENTITY. ANY DIVULGING OF THIS DATA TO A THIRD PARTY IS PROHIBITED	DATE09/25/24
REVISION 2	NP - 11/25/24		
REVISION 3	NP - 12/11/24		
REVISION 4	DF - 01/08/25		
REVISION 5	-		
REVISION 6	-		

SALESDWG/Philadelphia/18ft Water Rescue/NP/09252024



705 13TH STREET, LAKE PARK, FL
800-848-6652

Philadelphia Police Marine Unit Philadelphia, PA

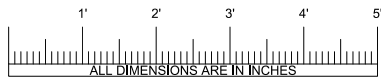
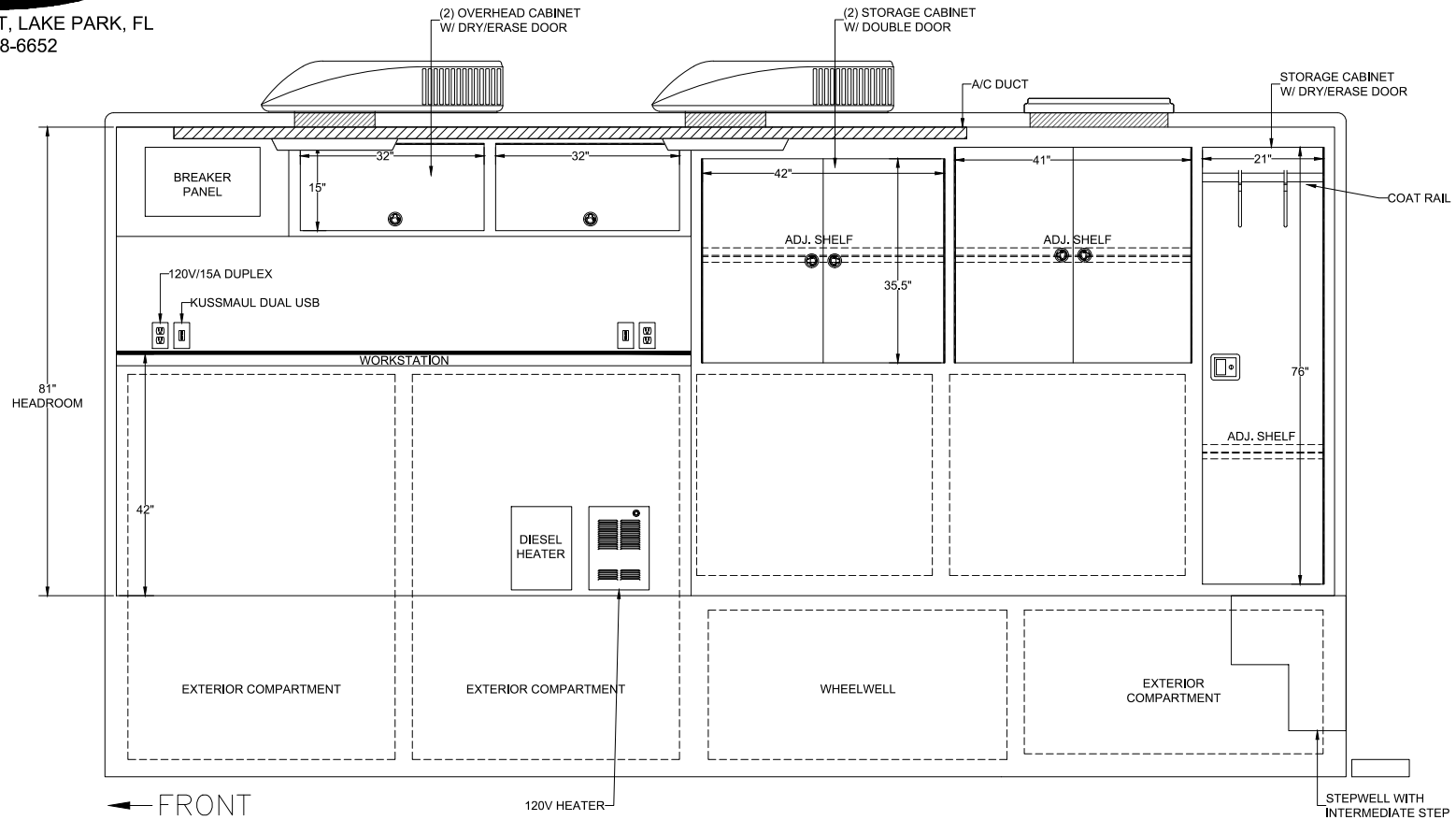

Curbside Interior

PRELIMINARY

NOTICE: THIS DRAWING IS A REPRESENTATION OF THE VEHICLE AND/OR COMPONENTS AS DESCRIBED IN THE SPECIFICATIONS PER THE DATE SHOWN. EVI RESERVES THE RIGHT TO MAKE CHANGES, AS NECESSARY, DURING THE PRODUCTION PROCESS TO ACCOMMODATE BEST MANUFACTURING PROCESSES AND TO ENSURE WE PROVIDE A CONSISTENTLY HIGH QUALITY PRODUCT.

REVISION 1	NP - 11/15/24	THESE DESIGN/ENGINEERING DRAWINGS ARE THE PROPERTY OF EMERGENCY VEHICLES, INC. THEY ARE PROPRIETARY AND ARE FOR THE EXCLUSIVE USE OF YOUR ENTITY. ANY DIVULGING OF THIS DATA TO A THIRD PARTY IS PROHIBITED	DATE 09/25/24
REVISION 2	NP - 11/25/24		
REVISION 3	NP - 12/11/24		
REVISION 4	DF - 01/08/25		
REVISION 5	-		
REVISION 6	-		



705 13TH STREET, LAKE PARK, FL
800-848-6652

Philadelphia Police Marine Unit Philadelphia, PA

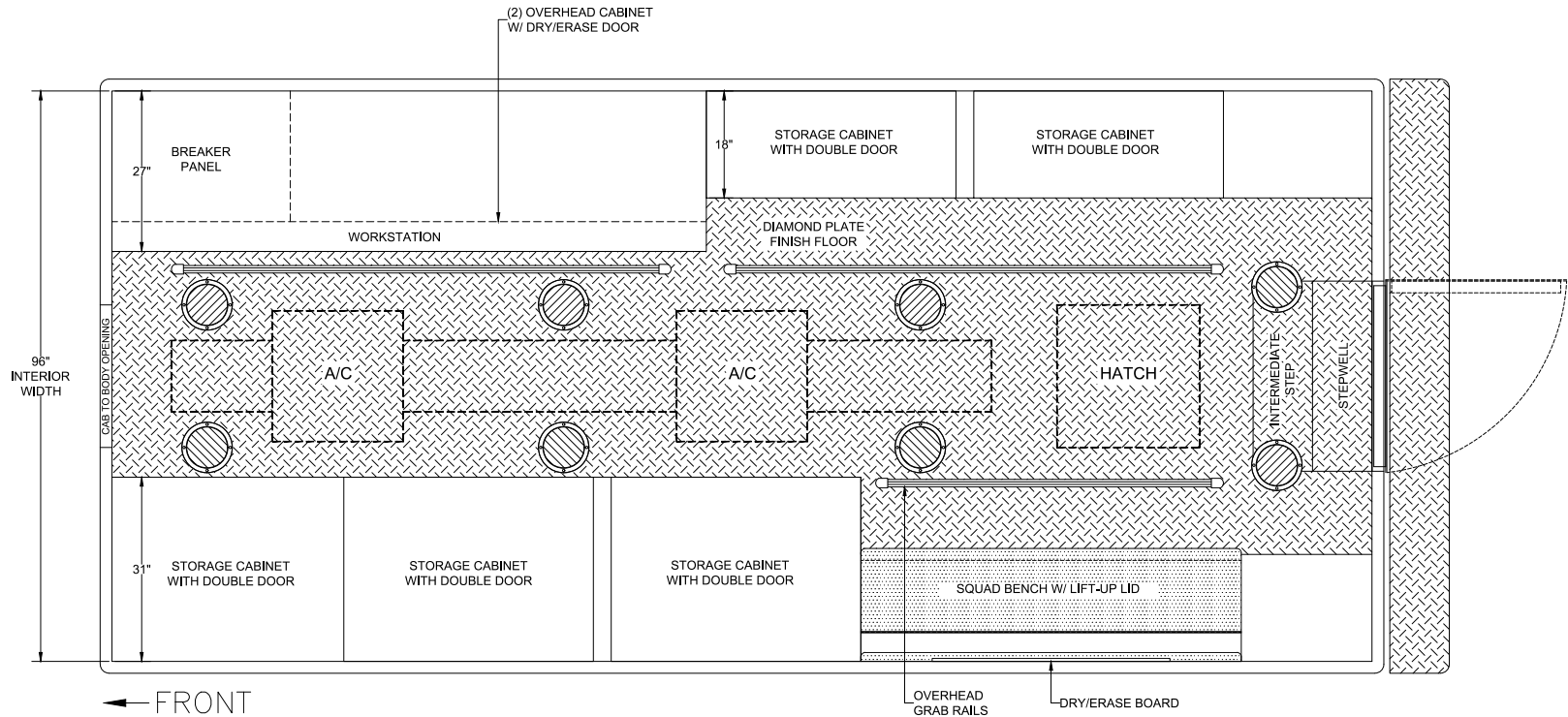

 WHELEN 8" WHITE/RED LED DOME LIGHT

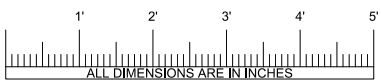

Body/Ceiling Planview

PRELIMINARY

NOTICE: THIS DRAWING IS A REPRESENTATION OF THE VEHICLE AND/OR COMPONENTS AS DESCRIBED IN THE SPECIFICATIONS PER THE DATE SHOWN. SWI RESERVES THE RIGHT TO MAKE CHANGES, AS NECESSARY, DURING THE PRODUCTION PROCESS TO ACCOMMODATE BEST MANUFACTURING PROCESSES AND TO ENSURE WE PROVIDE A CONSISTENTLY HIGH-QUALITY PRODUCT.

REVISION 1	NP - 11/15/24	THESE DESIGN/ENGINEERING DRAWINGS ARE THE PROPERTY OF EMERGENCY VEHICLES, INC. THEY ARE PROPRIETARY, AND ARE FOR THE EXCLUSIVE USE OF YOUR ENTITY. ANY DIVULGING OF THIS DATA TO A THIRD PARTY IS PROHIBITED.	DATE: 09/25/24
REVISION 2	NP - 11/25/24		
REVISION 3	NP - 12/11/24		
REVISION 4	DF - 01/08/25		
REVISION 5	-		
REVISION 6	-		