



# CITY OF HAZLETON (PA)

## Midmount Platform

GSO 11412



### CHASSIS

- KME Severe Service XMFD cab with flat roof
- Cummins X15 engine, 605 HP, 1850 ft-lb. torque; Allison 4500EVS transmission with retarder
- Valor seating for five firefighters
- Two cab external EMS compartments with internal access
- 110,000 PSI steel triple frame rail
- Hendrickson Steertek 24,000-pound front axle and suspension
- Meritor rear axle with 58,000-pound Raydan Air Ride Suspension

### ELECTRIC & WARNING

- Whelen warning light system
- HiViz brow and scene lights
- FRC scene lights on aerial platform
- 10KW hydraulic generator
- Two Hannay electric reels with 200' of 10/4 cable

### BODY FEATURES

- 1/8-inch aluminum body with steel subframe
- Full depth compartments on driver's and officer's sides
- Mitered body corners for reduced tail swing
- Six-bottle cascade system with Bauer fill station
- Storage for more than 150 feet of ground ladders in torque box

### AERIAL

- 84-foot aerial platform with 2.5:1 safety factor
- Aerial manufactured from 100,000 PSI steel for maximum strength
- Plus-80 degrees to minus-12 degrees aerial operation
- 50 MPH wind rating with 1/4-inch of ice buildup
- 1,000-pound platform capacity through complete operating envelope of aerial
- 500-pound platform capacity while flowing water
- TFT Monsoon RC monitor with flow up to 2,000 GPM
- Amdor Pathfinder aerial lighting

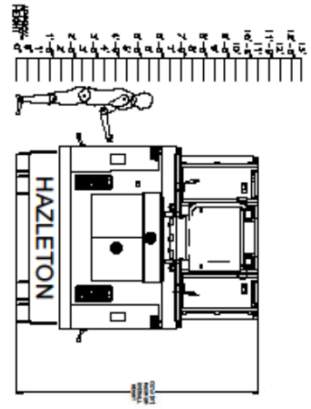

502 INTERIOR PLAN VIEW

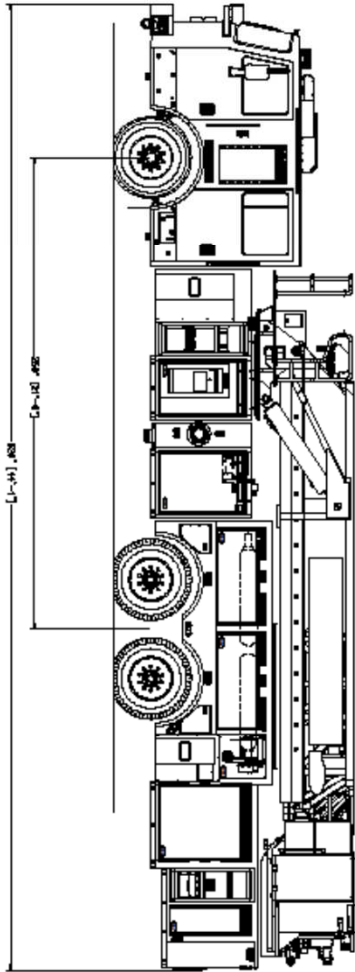
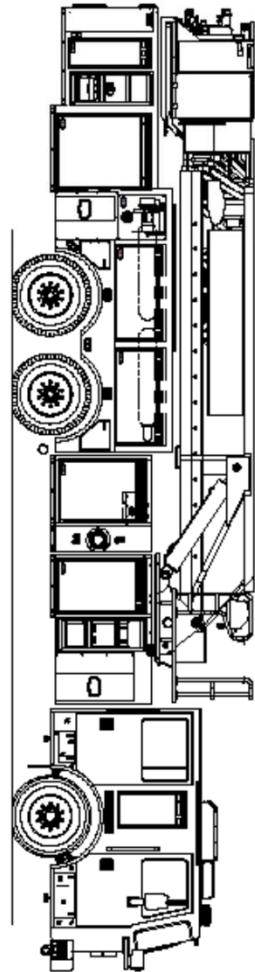
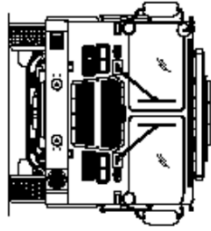
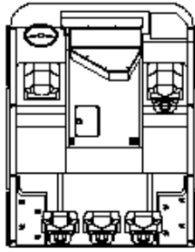

NO.	REV.	DATE	BY	CHKD.	DESCRIPTION
1					ISSUED FOR APPROVAL
2					REVISED PER COMMENTS
3					REVISED PER COMMENTS
4					REVISED PER COMMENTS
5					REVISED PER COMMENTS
6					REVISED PER COMMENTS
7					REVISED PER COMMENTS
8					REVISED PER COMMENTS
9					REVISED PER COMMENTS
10					REVISED PER COMMENTS
11					REVISED PER COMMENTS
12					REVISED PER COMMENTS
13					REVISED PER COMMENTS
14					REVISED PER COMMENTS
15					REVISED PER COMMENTS
16					REVISED PER COMMENTS
17					REVISED PER COMMENTS
18					REVISED PER COMMENTS
19					REVISED PER COMMENTS
20					REVISED PER COMMENTS
21					REVISED PER COMMENTS
22					REVISED PER COMMENTS
23					REVISED PER COMMENTS
24					REVISED PER COMMENTS
25					REVISED PER COMMENTS
26					REVISED PER COMMENTS
27					REVISED PER COMMENTS
28					REVISED PER COMMENTS
29					REVISED PER COMMENTS
30					REVISED PER COMMENTS
31					REVISED PER COMMENTS
32					REVISED PER COMMENTS
33					REVISED PER COMMENTS
34					REVISED PER COMMENTS
35					REVISED PER COMMENTS
36					REVISED PER COMMENTS
37					REVISED PER COMMENTS
38					REVISED PER COMMENTS
39					REVISED PER COMMENTS
40					REVISED PER COMMENTS
41					REVISED PER COMMENTS
42					REVISED PER COMMENTS
43					REVISED PER COMMENTS
44					REVISED PER COMMENTS
45					REVISED PER COMMENTS
46					REVISED PER COMMENTS
47					REVISED PER COMMENTS
48					REVISED PER COMMENTS
49					REVISED PER COMMENTS
50					REVISED PER COMMENTS
51					REVISED PER COMMENTS
52					REVISED PER COMMENTS
53					REVISED PER COMMENTS
54					REVISED PER COMMENTS
55					REVISED PER COMMENTS
56					REVISED PER COMMENTS
57					REVISED PER COMMENTS
58					REVISED PER COMMENTS
59					REVISED PER COMMENTS
60					REVISED PER COMMENTS
61					REVISED PER COMMENTS
62					REVISED PER COMMENTS
63					REVISED PER COMMENTS
64					REVISED PER COMMENTS
65					REVISED PER COMMENTS
66					REVISED PER COMMENTS
67					REVISED PER COMMENTS
68					REVISED PER COMMENTS
69					REVISED PER COMMENTS
70					REVISED PER COMMENTS
71					REVISED PER COMMENTS
72					REVISED PER COMMENTS
73					REVISED PER COMMENTS
74					REVISED PER COMMENTS
75					REVISED PER COMMENTS
76					REVISED PER COMMENTS
77					REVISED PER COMMENTS
78					REVISED PER COMMENTS
79					REVISED PER COMMENTS
80					REVISED PER COMMENTS
81					REVISED PER COMMENTS
82					REVISED PER COMMENTS
83					REVISED PER COMMENTS
84					REVISED PER COMMENTS
85					REVISED PER COMMENTS
86					REVISED PER COMMENTS
87					REVISED PER COMMENTS
88					REVISED PER COMMENTS
89					REVISED PER COMMENTS
90					REVISED PER COMMENTS
91					REVISED PER COMMENTS
92					REVISED PER COMMENTS
93					REVISED PER COMMENTS
94					REVISED PER COMMENTS
95					REVISED PER COMMENTS
96					REVISED PER COMMENTS
97					REVISED PER COMMENTS
98					REVISED PER COMMENTS
99					REVISED PER COMMENTS
100					REVISED PER COMMENTS

KME  
 KME INDUSTRIES, INC.  
 1000 W. 10TH AVENUE  
 DENVER, CO 80202  
 (303) 733-1000  
 FAX (303) 733-1001  
 WWW.KME.COM